

USER INSTRUCTIONS

GENERAL

ATTENTION

Thank you for purchasing this product.

Please read the following important information regarding installation safety, operating the product and maintenance instructions. Keep this information booklet accessible for further consultations. The appliance has been designed for use in a ducting version (air exhaust to the outside) and a recommended 2 – 4 burner cooker hob.

To avoid unexpected drop of range hood, pls drive a M4*16 screw through the center round hole on the hanger.

If you find any abnormality with the product, please contact the retailer or agent you've purchased from.

We would like to advice that all installation and after sales service repairs should be carried out by certified electricians or our authorised contractors.

CONTENTS	PAGE NUMBER
• Component list & Accessories -----	1
• Installation -----	1-3
• Operation -----	3-5
• Maintenance -----	5
• Electrical Diagram-----	5-7
• Main Parts Diagram -----	7
• Warranty & After Sales Support-----	8
• Troubleshoot -----	9

Component list & Accessories

1. Main body assembly x 1 unit
2. Main body mounting bracket x 1 pc
3. Flow exit x 1 pc
4. Flow exit seal x 1 pc
5. Oil collection container x 1 pc
6. Flexible exhaust duct x 1 pc
7. User Instructions manual x 1 booklet
8. Screw kit x 1

Installation

Caution: Assembly and electrical connections must be carried out by certified electrician or our authorised contractor.

Clearance between cook hob and the range hood:

“T” shape range hood

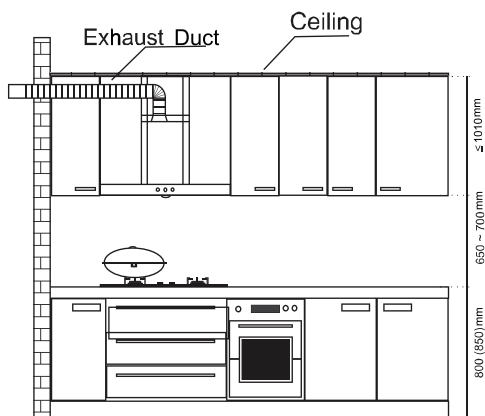

Slide range hood

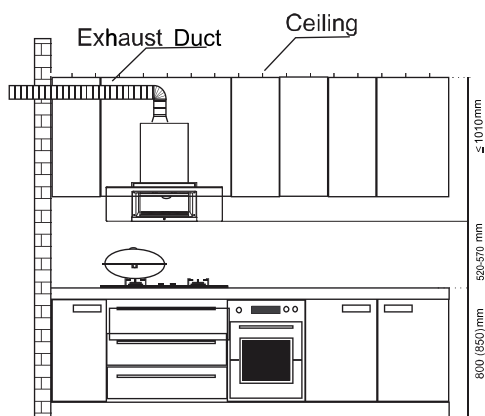

- Any distance above 700mm will affect the performance of this range hood.
- Do not connect the range hood exhaust to the same conductor used to circulate hot air or for evacuating fumes from other appliances generated by other than an electrical source.

If the hood is installed under a low ceiling without the extended chimney, there should be a minimum of 30mm gap between the ceiling and the main chimney.

In order to obtain optimal air extraction:

- Keep exhaust duct short and straight.
- Do not reduce the size or restrict the exhaust duct.
- Minimize bends.
- Make sure the helix of the flexible exhaust duct is tightly drawn rather than slacking.

Installation sequence

Top View

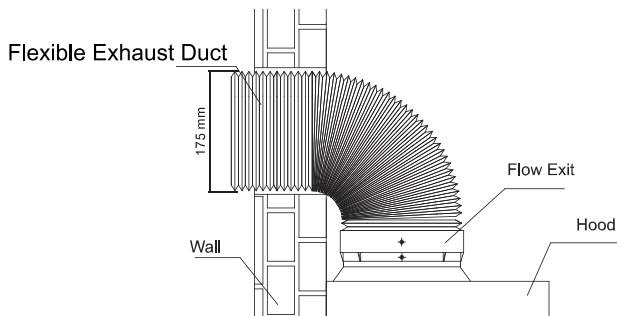
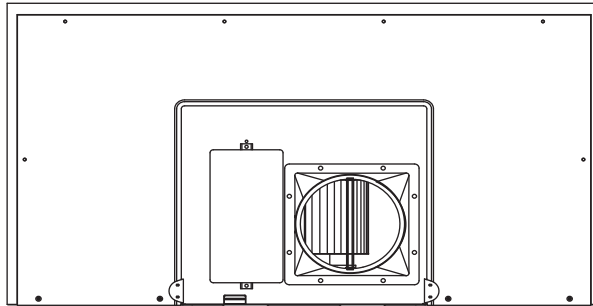

1. Determine height between cooker hob and base of hood.
2. Mark wall to suit all bracket locations. Drill holes of 50mm depth at the selected drilling position.
3. Insert the expansion tubes to fix the bracket onto the wall.
4. Install the flow exit to the hood and follow by connecting the flexible exhaust duct to the flow exit.
5. Strengthened the connection between the flow exit and the flexible exhaust duct with screws.
6. Lift and hang the hood to the wall bracket and please ensure it sits firmly on the bracket.
7. Direct the other end of the flexible exhaust duct to the outlet or wall.
8. Fit in the safety baffle of the hood onto the wall to strengthen the position and to reduce vibration when the hood is switched on.
9. Chimney extension can be installed to the ceiling or wall.
10. Ensure the oil collection container is in place before the hood is being used. To remove it for cleaning, slide the oil collection container from front to rear, vice versa for inserting it into position.

Safety Precaution

- o Ensure there is proper ventilation in the cooking area.
- o Do not perform Flambé under the hood.
- o Avoid using materials which could cause spurts of flame near the hood.
- o Do not modify the hood. Dismantle and repair can only be done by certified electrician or our authorised contractor.

Operation



A:) Press button A to set the alarm time, adjust time by button D/E , switch from hour to minute by pressing button G and confirm setting by button G.

Remark: Default alarm time: 10 minutes.

B:) Press button B for 3 seconds to start holiday function, range hood will automatically start working for 15 mins at the lowest fan speed. (Time setting procedure: Adjust time by button D/E, switch from hour to minute by button G and confirm setting by pressing button G.)

Remark: Default holiday function time: 14:00 PM

C:) Press button C to turn on/off light. (Button C may also be )

D:) Press button D to reduce fan speed.

E:) Press button E to increase fan speed.

F:) Press button F to start delay-off function, press twice to turn off the range hood.

G:) Press button G to set the clock time/ delay-off time. Press to set the hour, adjust by button D/E, switch from hour to minute by button G. Press button G for the third time to adjust delay-off time. (Adjusting range: 1~30Mins). Press button G fourth to confirm setting.

H:) Press button H to turn on/off the motor.

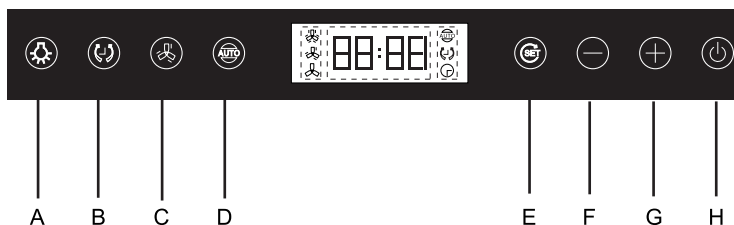

- A:) Press button A to turn on/off light. (Button A may also be )
- B:) Press button B for 5 seconds to start holiday function, range hood will automatically start working for 15 mins at the lowest fan speed. (Time setting procedure: Adjust time by button F/G, switch from hour to minute by button E and confirm setting by pressing button E.)
- C:) Press button C to turn on/off the motor.
- D:) Press button D to start auto sensor function.
- E:) Press button E to set the clock time/ delay-off time. Press to set the hour, adjust by button F/G, switch from hour to minute by button E. Press button E for the third time to adjust delay-off time. (Adjusting range: 1~30Mins). Press button fourth E to confirm setting.
- F:) Press button F to reduce fan speed.
- G:) Press button G to increase fan speed.
- H:) Press button H to start delay-off function, press twice to turn off the range hood.

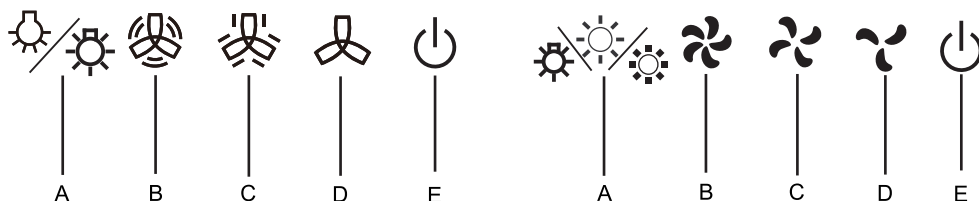

- A:) Press button A to turn on/off the light.
- B:) Press button B/C/D to adjust the fan speed.
- E:) Press button E to start delay-off function and press again to stop motor.

Remark: 1.) Press button E for 5 seconds to start auto sensor function. (Only some models have this function.)

2.) Press button B for 3 seconds to show the instantaneous fan speed. (Only some models have this function.)

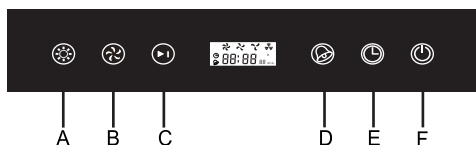

- A:) Press button A to turn on/off light. (Button A may also be )
- B:) Press button B to turn on/off the fan.
- C:) Press button C to adjust fan speed.
- D:) Press button D to set the alarm time, adjust time by button B/C , switch from hour to minute by pressing button D.
- E:) Press button E to set clock time, adjust time by button B/C , switch from hour to minute by pressing button E and confirm setting by button E.
- F:) Press button F to turn on/off the range hood.

Maintenance

1. It is always recommended to switch off the hood before the maintenance and cleaning routine is being carried out.
2. Pls wear safety gloves during cleaning as there are sharp edges on the unit and accessories may cause injuries.
3. Empty on the oil collection container regularly to avoid overflow and prevent unpleasant stains.
4. Thorough cleaning on the hood is recommended every 6 months, and a shorter interval if heavy cooking is a regular practice.
5. Use a cloth which has been dampend with denatured alcohol or neutral, non-abrasive liquid detergents.
6. The light on the hood is designed to use during cooking for general room illumination. Extended use of the light reduces the average duration of the bulb.

Electrical Diagram

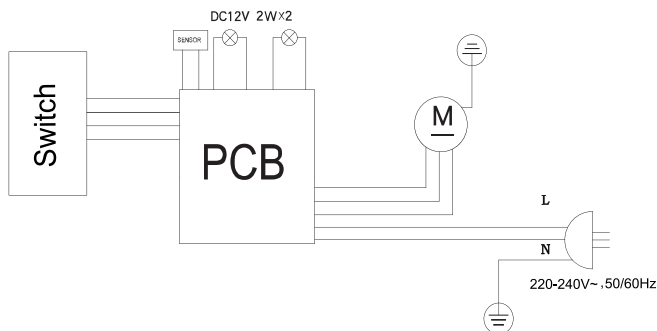

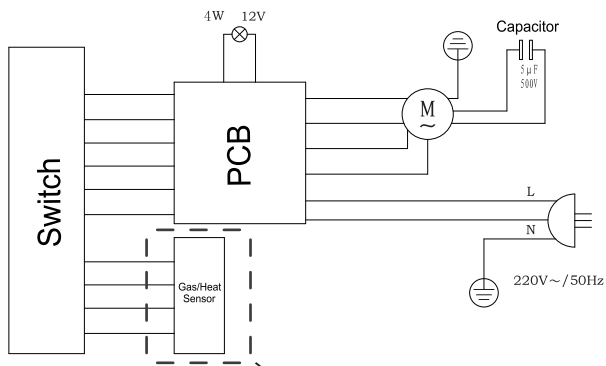
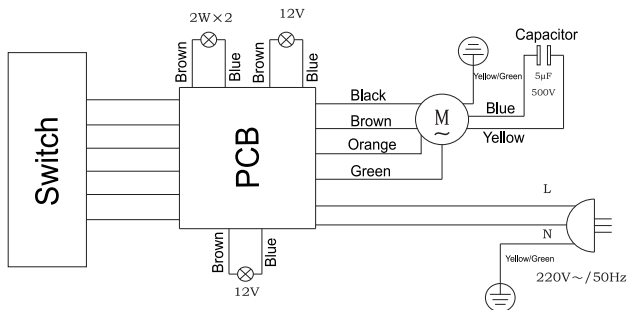
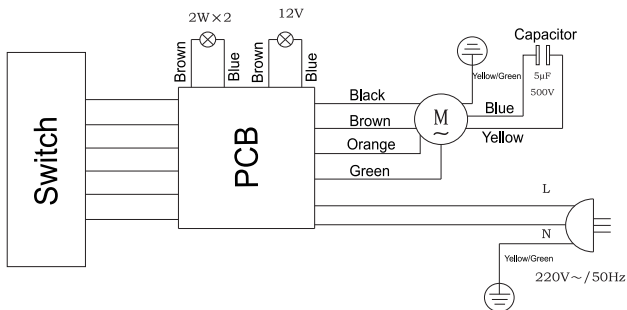
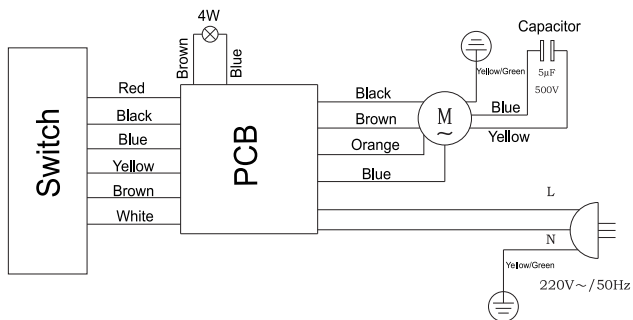

(Only some specific model have this part)

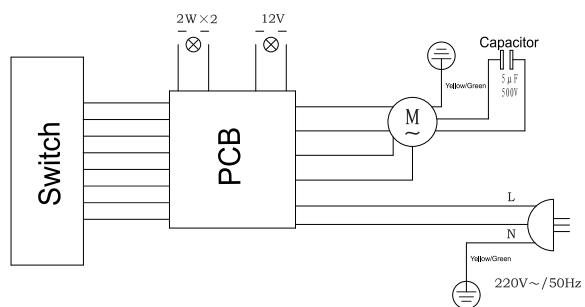

Main Parts Diagram

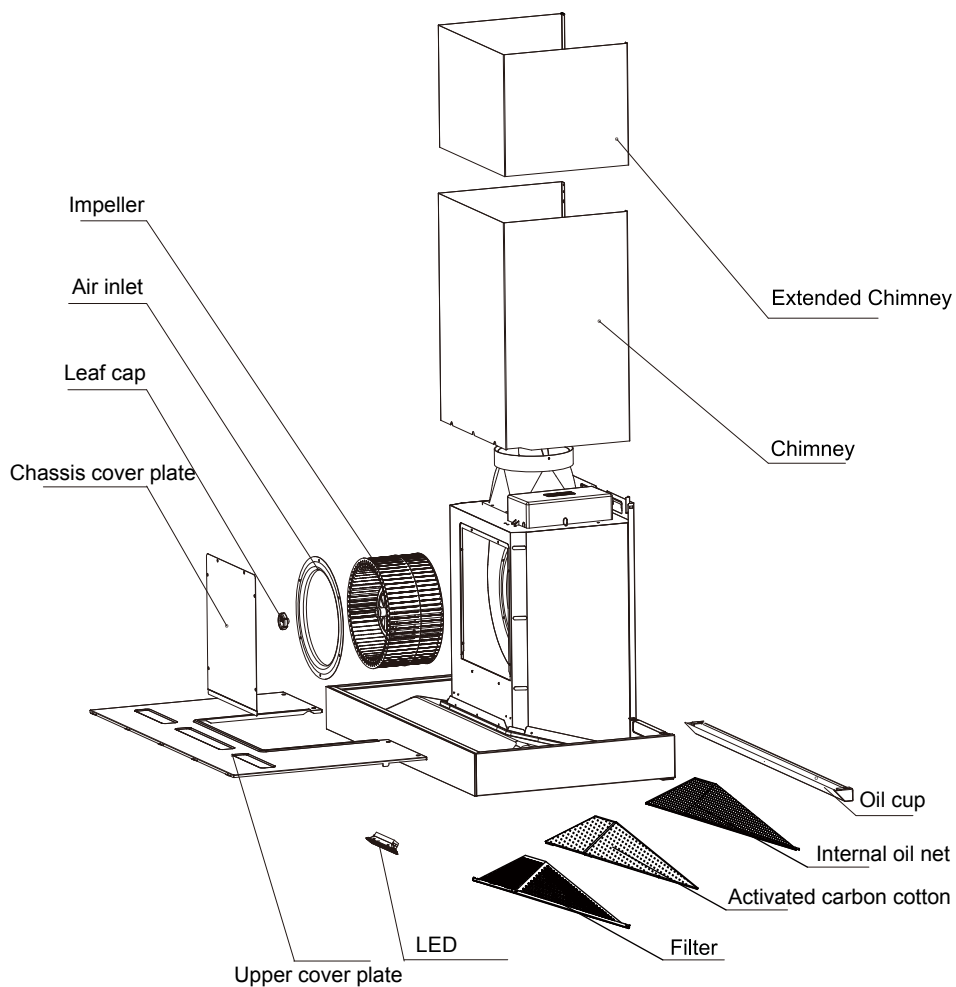

Warranty & After Sales Support

We undertake that if within 24 months of the date of the purchase this appliance or any part thereof is proved to be defective by reason only faulty workmanship or materials, we will, at our option repair or replace the same Free of Charge for labour, materials or carriage on condition that:

- The appliance has been correctly installed and used only on the electricity supply stated on the rating plate.
- The appliance has been used for normal domestic purposes only, and in accordance with the manufacturer's instructions.
- The appliance has not been serviced, maintained, repaired, taken apart or tampered with by any person not authorized by us.
- This warranty does not include maintenance, like cleaning of the hood and accessories, e.g: flexible exhaust duct, oil collection container, wall bracket.
- All service or repair work under this warranty must be undertaken by us.
Any appliance or defective part replaced shall become our property.
- The manufacturer declines all responsibility for eventual damages caused by breaching of the above warnings.

If you need any technical help or would like more information about our products, please do not hesitate to contact us.

After each use of the lampblack, please wipe the outside surface of the lampblack once every six months to clean the air inlet net cover, according to the use of activated carbon filter cotton, every 36 months to clean the impeller once (this is only for professional cleaning).

Troubleshoot

- If the hood fails to work properly, please carry out the following checks:

PROBLEM	POSSIBLE CAUSES	SOLUTION
Motor and light do not operate	Power plug is not inserted completely	Check the plug and insert it properly
	The light bulbs are blown	Replace the bulbs
	The wire and / or cable is disconnected	Contact us
	The light's transformer is damaged	Contact us
Motor cannot operate but the lights are working	The impeller has stopped	Contact us
	The capacitor is disconnected and / or damaged	Contact us
	The motor is damaged	Contact us
The range hood vibrates or shakes while in operation	The range hood is not installed levelly or the wall which it is installed upon is not solid	Relocation of the hood or strengthening the wall is required
	The motor is not properly installed	Contact us
	The damaged impeller is affecting the levelness of the range hood	Contact us
Only one or two buttons can function while others are not working	The control panel is not functioning properly	Contact us
	Connection with the control board is loose	Contact us
Weak / Low Extraction Performance	The range hood is installed too high from the cooking hob	Reinstall the hood to a lower position
	There are blockages in the exhaust duct.	Remove the dirt / blockages inside the duct
	Air convection is too strong around the appliance	Avoid opening too many windows or doors to improve the extraction performance
Oil Leakage	The range hood is not installed levelly	Reinstall the hood to a much level position

- If the problem persists even after all these checks, please contact us.

